



# NOVA™ GLASS DOOR FREEZERS -15°F



NX211

NX482

PROJECT:  
 .....  
 ITEM NUMBER:  
 .....  
 MODEL NUMBER:  
 .....

1 & 2 door DISPLAY Freezers

## SPECIFICATIONS FOR: NX211SMG/8 & NX482SMG/8

- **Exterior finish:** Exterior front and sides are stainless steel. The exterior top, bottom and back are galvanized steel. All exterior joints and seams fold in without lap joints. No exposed raw edges.
- **Interior finish:** Interior liner is smooth aluminum.
- **Insulation:** The complete cabinet is foamed-in-place with polyurethane insulation.
- **Hardware:** Heavy duty, pivot hinges with hold open devices; key locks; pull handles; self adjusting magnetic gaskets; 6" legs and 3 epoxy coated shelves per door section - standard.
- **Glass doors:** Each glass door provides 9.6 square feet of clear glass viewing space. Glass is tempered, three pane, heated thermopane.
- **Electrical:** All models are standard with complete perimeter, anti-condensate door opening heater wires and interior fluorescent lighting activated by a manual switch.
- **Instrumentation:** Microprocessor control with integrated digital display.
- **Refrigeration:** Top mounted refrigeration system, copper tube, aluminum fin evaporator. The condensate is collected and automatically evaporated from an electric condensate evaporator. Refrigerant flow is controlled by a thermostatic expansion valve increasing the ability of the freezer to meet varying load conditions. Operating temperature: -15°F.
- **Approvals:** UL listed.  
 C-UL listed.\*\*  
 UL Sanitation listed.\*\*

### STANDARD FEATURES

- Air-cooled condensing unit
- Aluminum interior
- Automatic condensate evaporation
- Automatic defrost
- Door opening heaters
- Expansion valve system
- Epoxy coated shelves
- Fluorescent lighting
- Heated three pane, tempered glass doors
- Key locks
- 6" legs
- Magnetic gasketing
- Microprocessor control with digital display
- Operating temperature: -15°F
- Polyurethane insulation
- Stainless steel exterior
- Stocked for same day shipment
- UL, C-UL & UL Sanitation listed\*\*
- Warranties: 90 day labor plus 1 year parts

### OPTIONAL FEATURES\*

- Alarm systems
- Casters (contact factory)
- Extra shelves
- Pressure relief valve
- Stainless steel back
- Stainless steel interior
- Warranties: 5 year compressor plus 1 year service



Nor-Lake, Inc.  
 Registered to ISO 9001:2000  
 File No. A3204

\* Most options are available two weeks from receipt of order. Please contact us for specific questions.  
 \*\*C-UL is Underwriters Laboratories Safety Certification Mark which indicates that UL has tested the equipment to applicable CSA Standards.  
 \*\*UL Sanitation is Underwriters Laboratories Sanitation Mark which indicates that UL has tested the equipment to applicable NSF Standards.

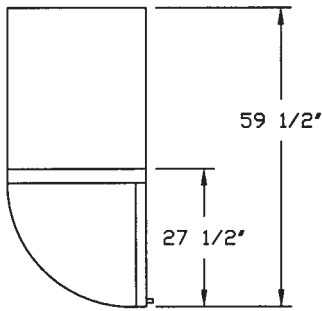

NX211

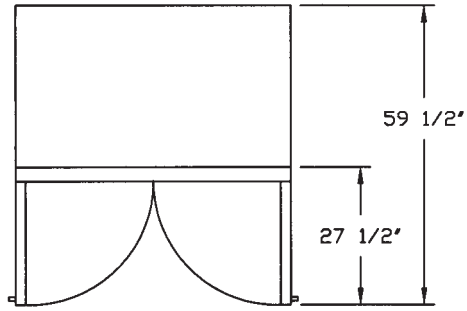

NX482

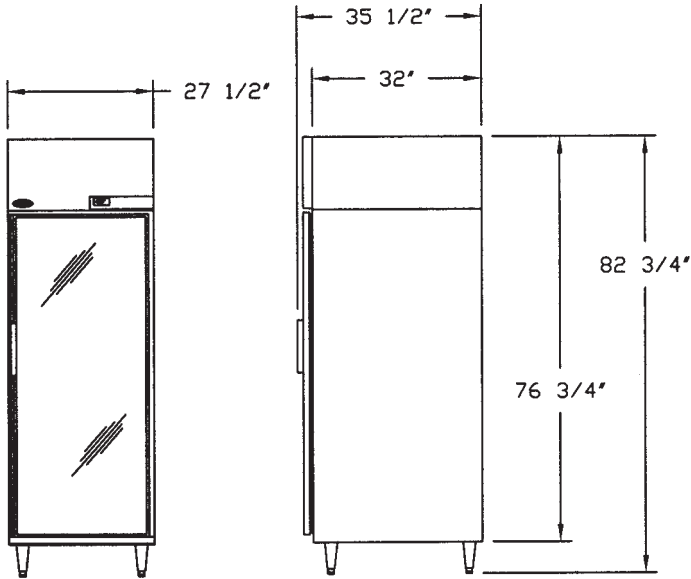

NX211

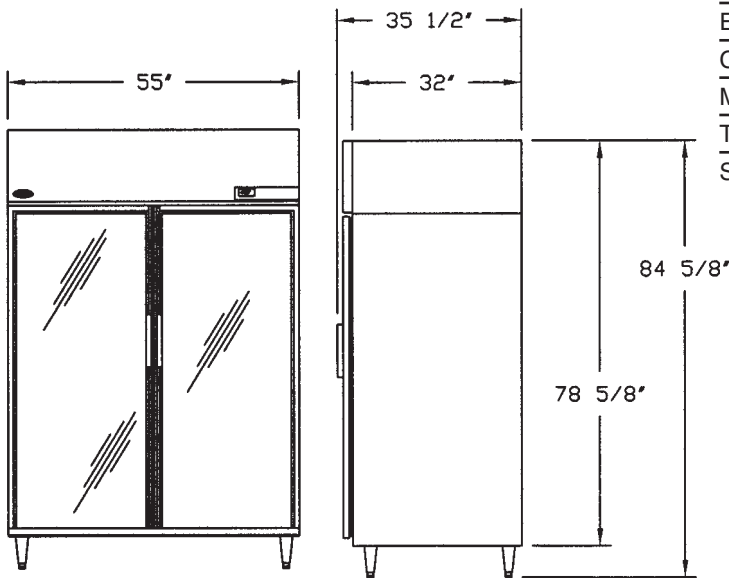

NX482

**SPECIFICATIONS**

	NX211	NX482
Crated Height	81"	83"
Crated Width	31"	59"
Crated Depth	38"	38"
Crated Weight (lbs)	500	750
Interior Height	59"	59"
Interior Width	23-1/2"	51"
Interior Depth	28"	28"
Overall Height	82-3/4"	84-5/8"
Overall Width	27-1/2"	55"
Overall Depth	35-1/2"	35-1/2"
Gross Cubage (ft. <sup>3</sup> )	22.5	48.8
Shelf Area (sq. ft.)	18.3	39.7
Glass Area (sq. ft.)	9.6	19.3
Number of Shelves	3	6
Number of Casters	4 Optional*	4 Optional*
Number of Legs*	4	4
Condensing Unit Size	3/4	1-1/2
Refrigerant	R404A	R404A
Electrical Characteristics	115/208-230/60/1	115/208-230/60/1
Cord & Plug Furnished*	No*	No*
Maximum Fuse Size	15	20
Total Amp Draw	9.6	15.3

Specifications subject to change without notice.

\* NX211 and NX482 models are available with a cord connection and casters. C-UL Listing not available with cord connected model. Contact the Factory.



**NORLAKE**

Revision Date: 9/04  
 © 2004 NOR-LAKE, INC.  
 Printed in the U.S.A.  
 Part Number: 040345

